

LPR 099 POLE - TECHNICAL DATA

1:20 SCALE

DESCRIPTION

STRUCTURE

Tapered steel S235JR pole.
(UNI EN 10025) Ø76-60 mm.

Flange cover in cast iron GLJ-200.
(UNI EN 1561).

Fitting in cast iron.
GLJ-200 (UNI EN 1561) Ø114-76 mm.

Cast aluminum fitting
(UNI EN 1706) Ø76-60 mm.

Threaded ¾ end sleeve in steel.
cold-dip galvanized.

Die-cast aluminum hatch.

Stainless steel hardware.

For details on the two types of ground anchorage, refer to the technical drawing.

PAINTING CYCLE

STEEL

Coat of two-component zinc phosphate primer and two coats of finish with two-component standard gray (S) paint. RAL colors on request.

CAST IRON

Sandblasting, immersion coat of zinc monocomponent, two-component zinc phosphate primer coat, two coats of finishing with standard gray two-component (S). RAL colors on request.

ALUMINIUM

Pickling and washing with water demineralized, nanotechnological process, drying at 160°C. Polyester powder primer coat and oven curing at 200°C. Finishing coat with two-component varnish standard gray color (S). RAL colors on request.

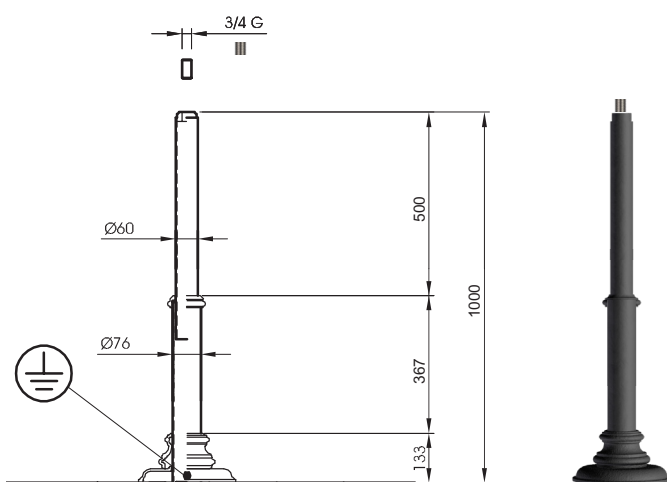

LPR 099 F
Pole with Flange